

This guide shows you how to replace your existing Slope and Motion Sensor (SMS) box with the new SMS box and accompanying brace. You can also use these instructions to remove or reinstall your existing SMS box.

## Parts list (if you ordered a new SMS box)

- 0.675 lb SMS Box
- SMS Mounting Brace
- 1/4-20 allen bolt (in SMS Mounting Brace)

## Required tools

- 5/32" allen wrench
- 3/16" allen wrench
- 7/16" socket and ratchet

## Preparing to replace your SMS Box and Brace

Before you begin replacing your SMS box, follow these procedures:

1. Slide the HCGG toward you on its slide rails so you can access and service the SMS box.
2. Turn off the SCCU.
3. Remove the door on the left (SMS side) of the HCGG.



1132 W 1700 N  
Logan, UT 84321 USA  
Phone: 435-753-1881  
Fax: 435-753-1896

HarvestMaster products are provided by Juniper Systems, Inc., a Campbell Scientific Company.

Part No.: 14918-01  
Date Released: October 2006  
Edited by: Charles Olson and Julie Johns

©Copyright 10-06, Juniper Systems, Inc. This information is subject to change without notice. The Juniper Systems logo is a registered trademark of Juniper Systems, Inc. Plot Harvest Data System, High Capacity GrainGage, Slope and Motion Sensor, and DataLink are recognized trademarks of Juniper Systems, Inc.

# Part 1: How to remove your old SMS Box

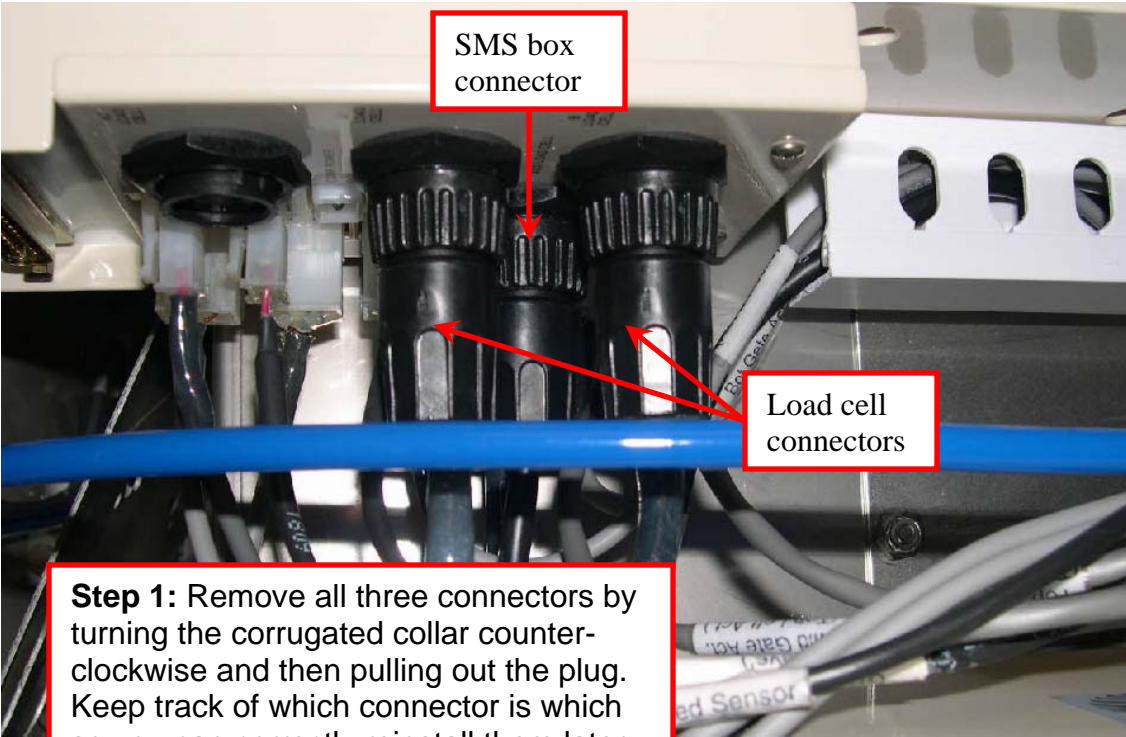

**Step 1:** Remove all three connectors by turning the corrugated collar counter-clockwise and then pulling out the plug. Keep track of which connector is which so you can correctly reinstall them later.

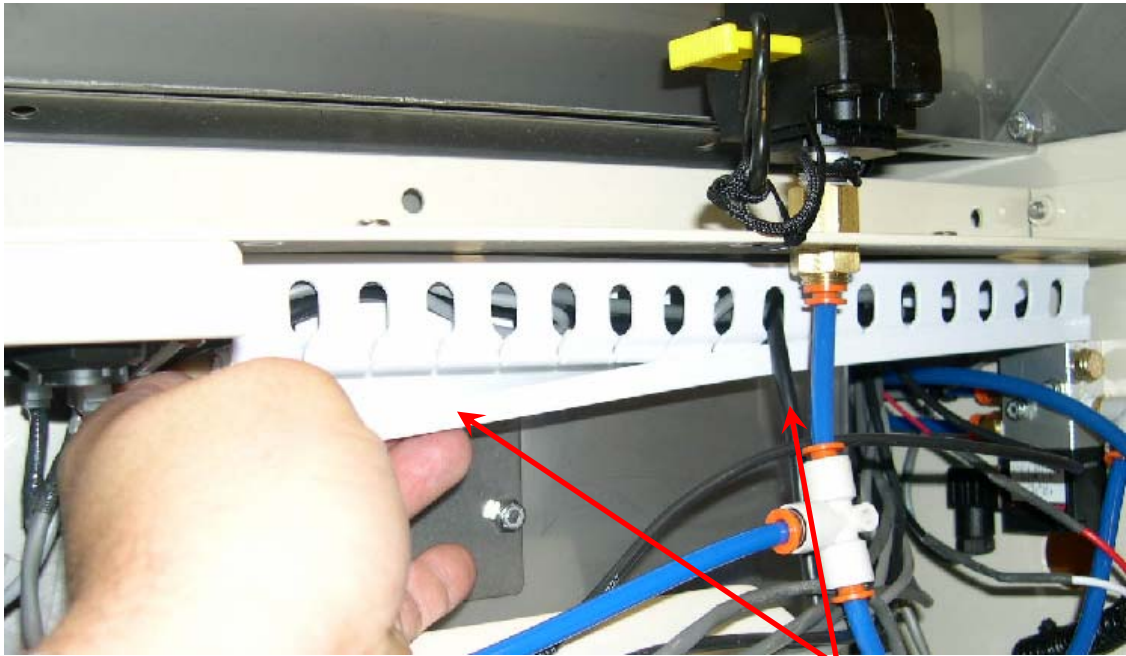

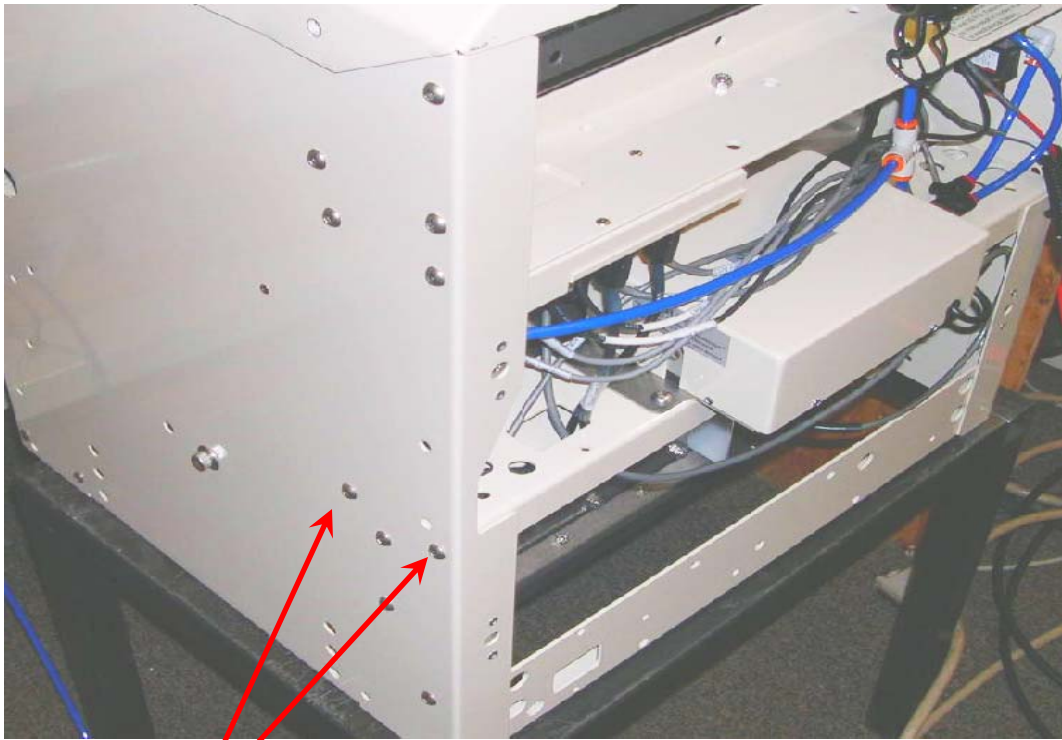

**Step 3:** Using a 5/32" allen wrench, remove these two bolts and the two on the opposite end of the SMS mounting beam.





**Step 4:** Grab the SMS box securely and rotate the SMS box and mounting beam toward you into a vertical position.



**Step 5:** Once the box is in the vertical position, move the SMS box and mounting beam up until the beam can be rotated past the lower beam. Be sure to move both ends of the mounting beam together to prevent the beam from binding.

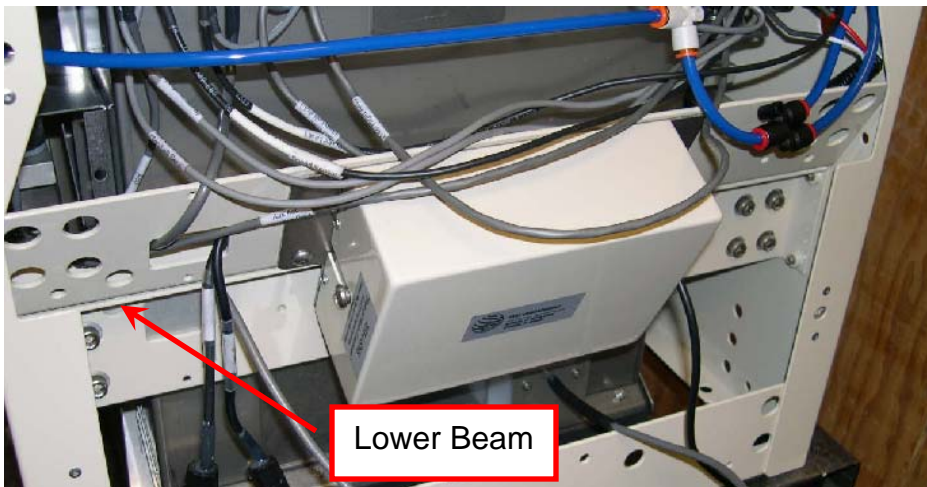

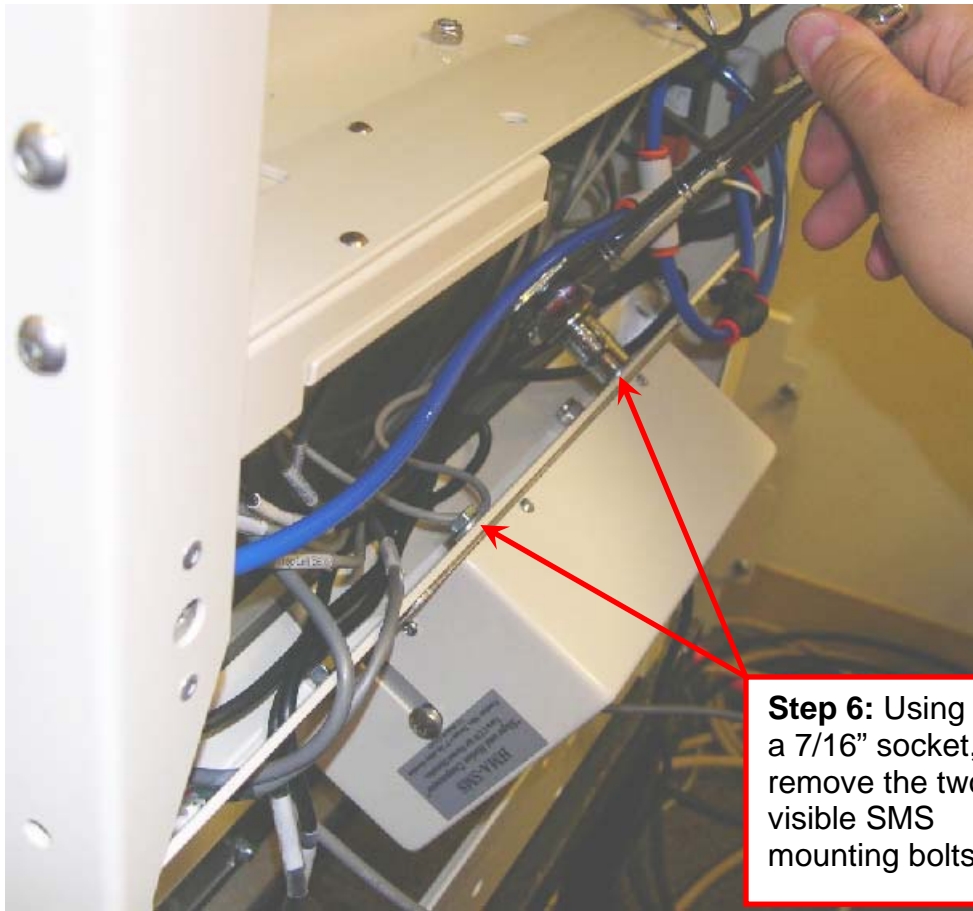

**Step 6:** Using a 7/16" socket, remove the two visible SMS mounting bolts.

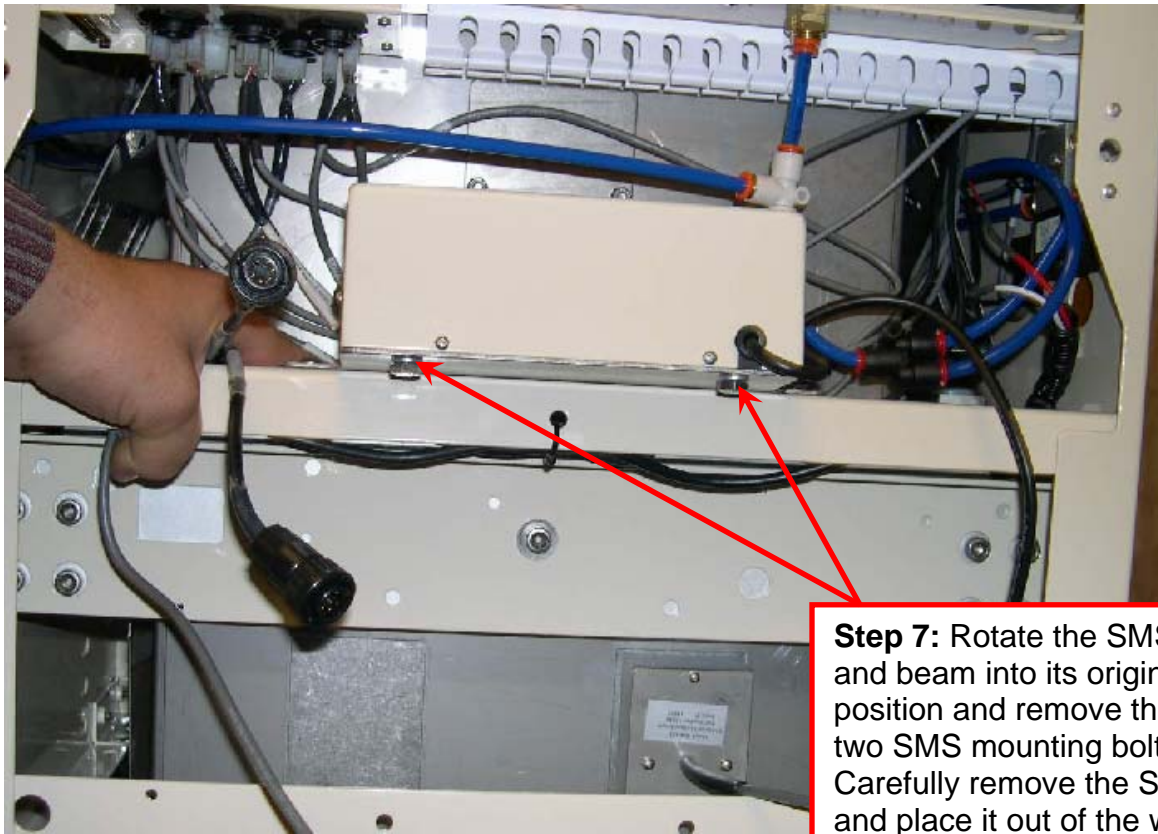

**Step 7:** Rotate the SMS box and beam into its original position and remove the other two SMS mounting bolts. Carefully remove the SMS box and place it out of the way.

## Part 2: How to install your new SMS box

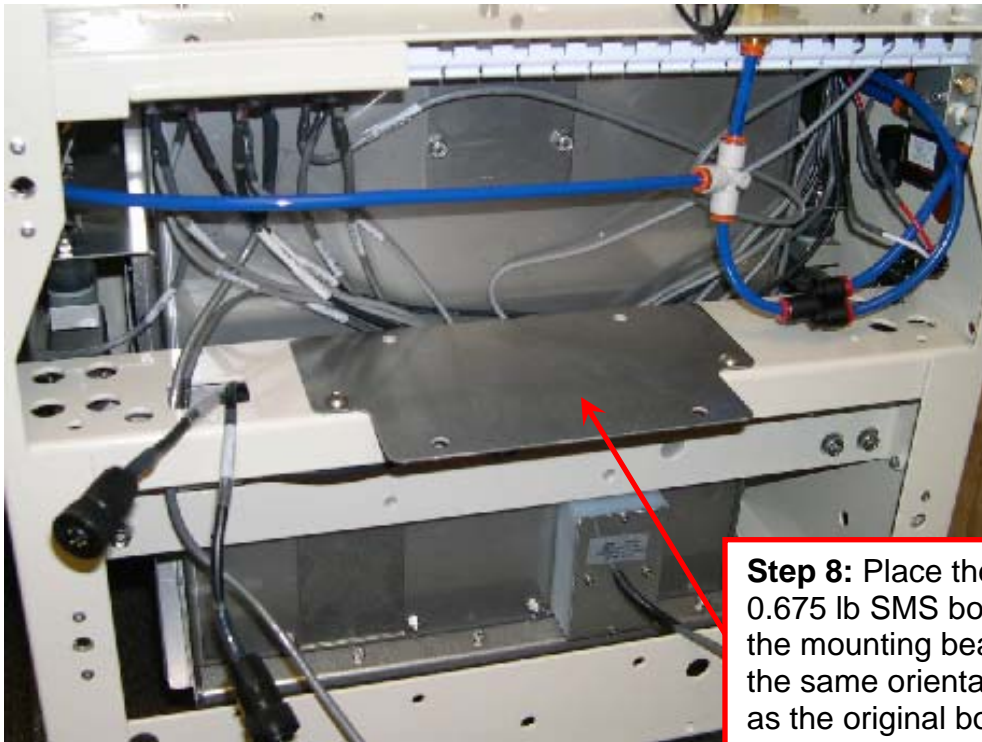

**Step 8:** Place the 0.675 lb SMS box on the mounting beam in the same orientation as the original box.

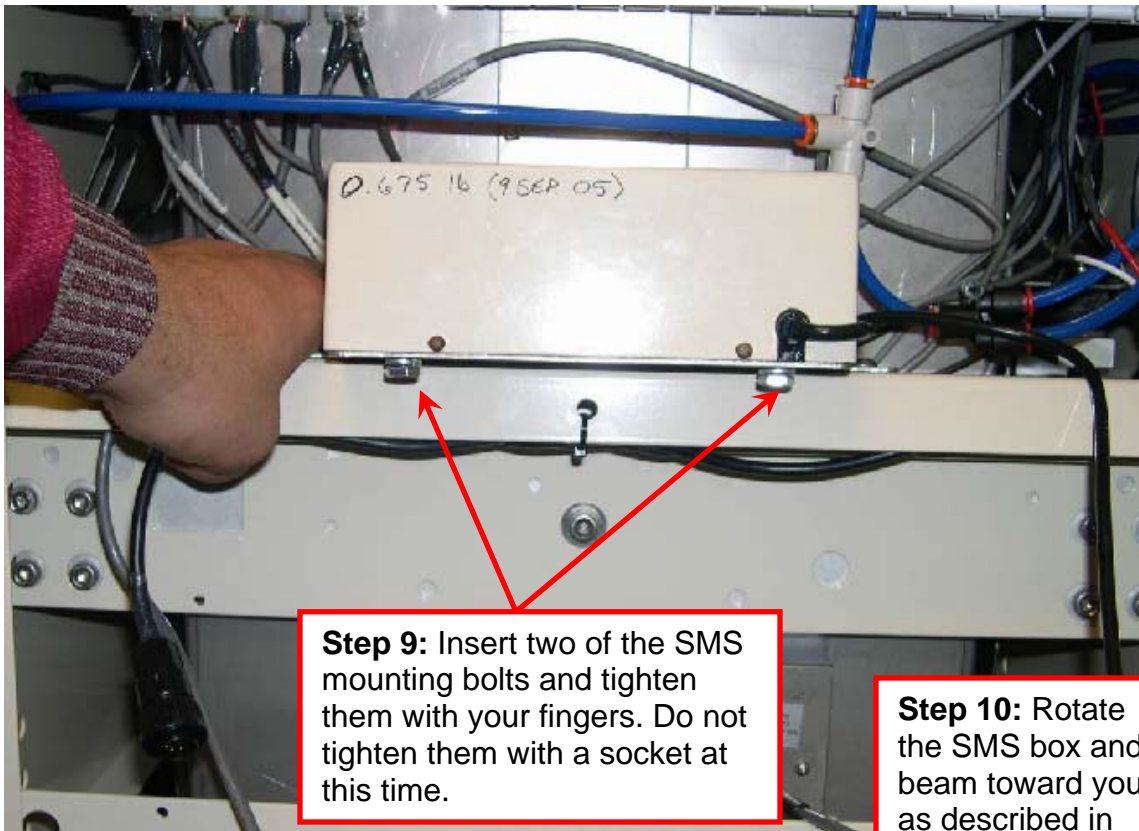

**Step 9:** Insert two of the SMS mounting bolts and tighten them with your fingers. Do not tighten them with a socket at this time.

**Step 10:** Rotate the SMS box and beam toward you as described in steps 4 and 5.



**Step 11:** Using a 3/16" allen wrench, remove the bolt in the brace provided.

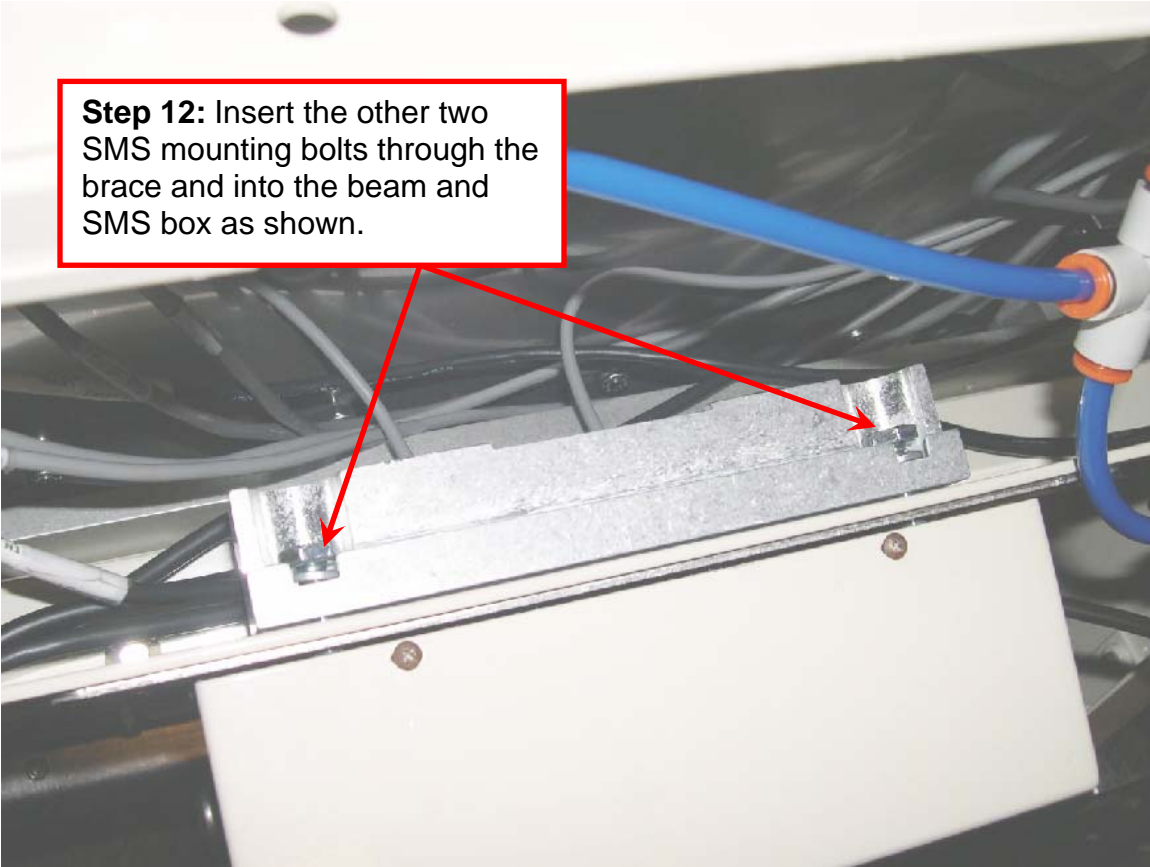

**Step 12:** Insert the other two SMS mounting bolts through the brace and into the beam and SMS box as shown.

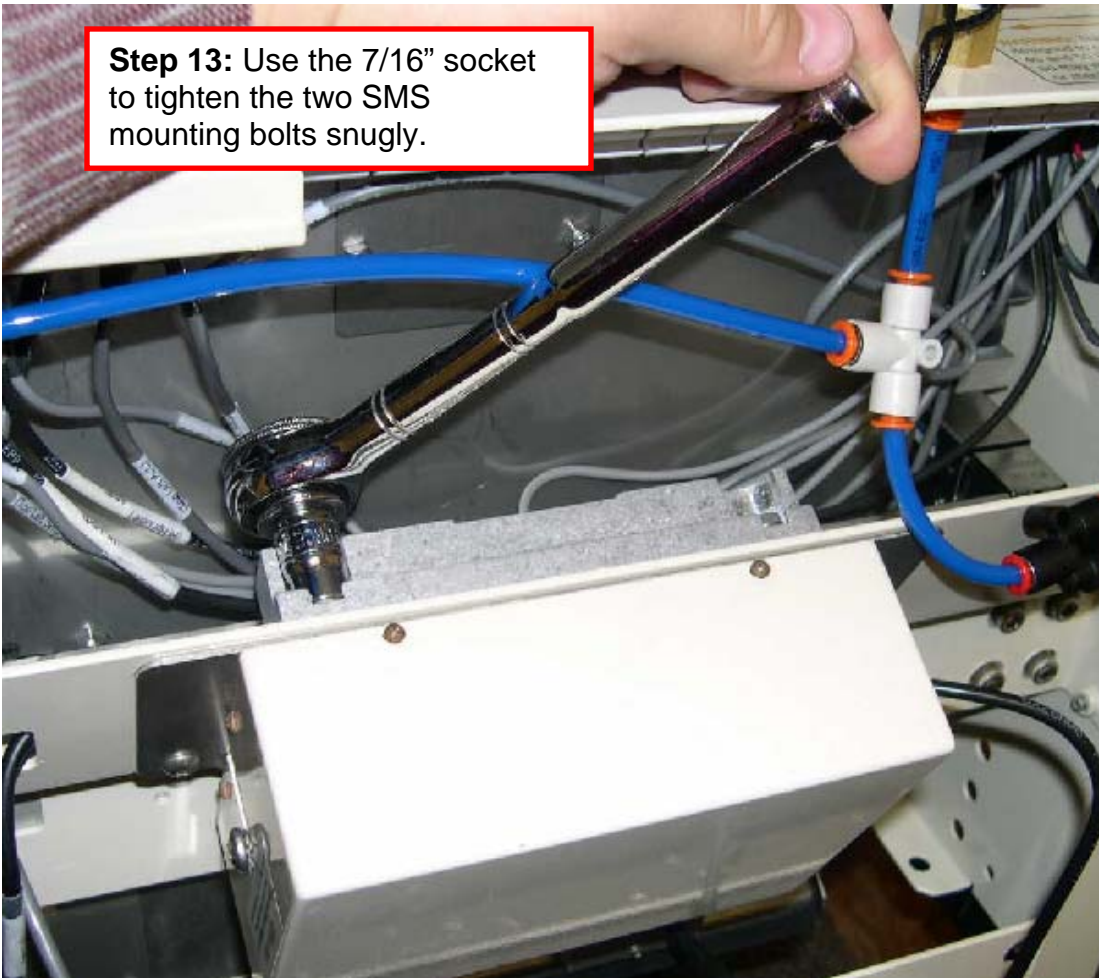

**Step 13:** Use the 7/16" socket to tighten the two SMS mounting bolts snugly.

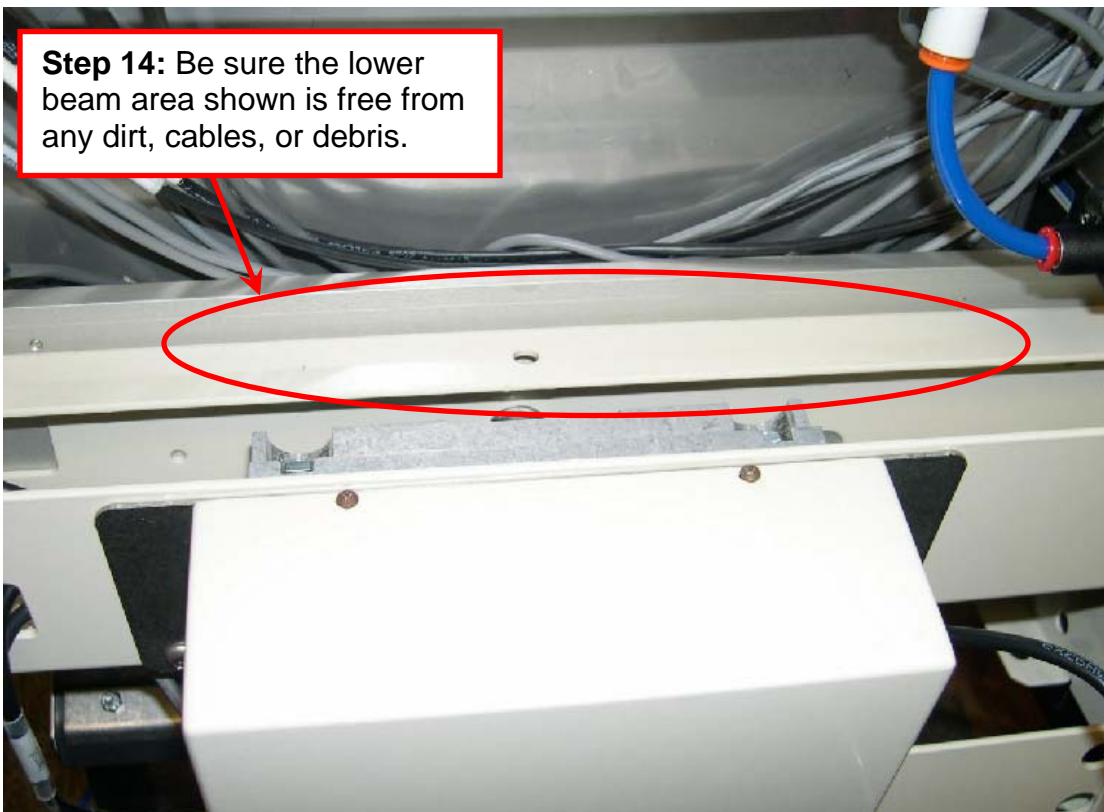

**Step 14:** Be sure the lower beam area shown is free from any dirt, cables, or debris.



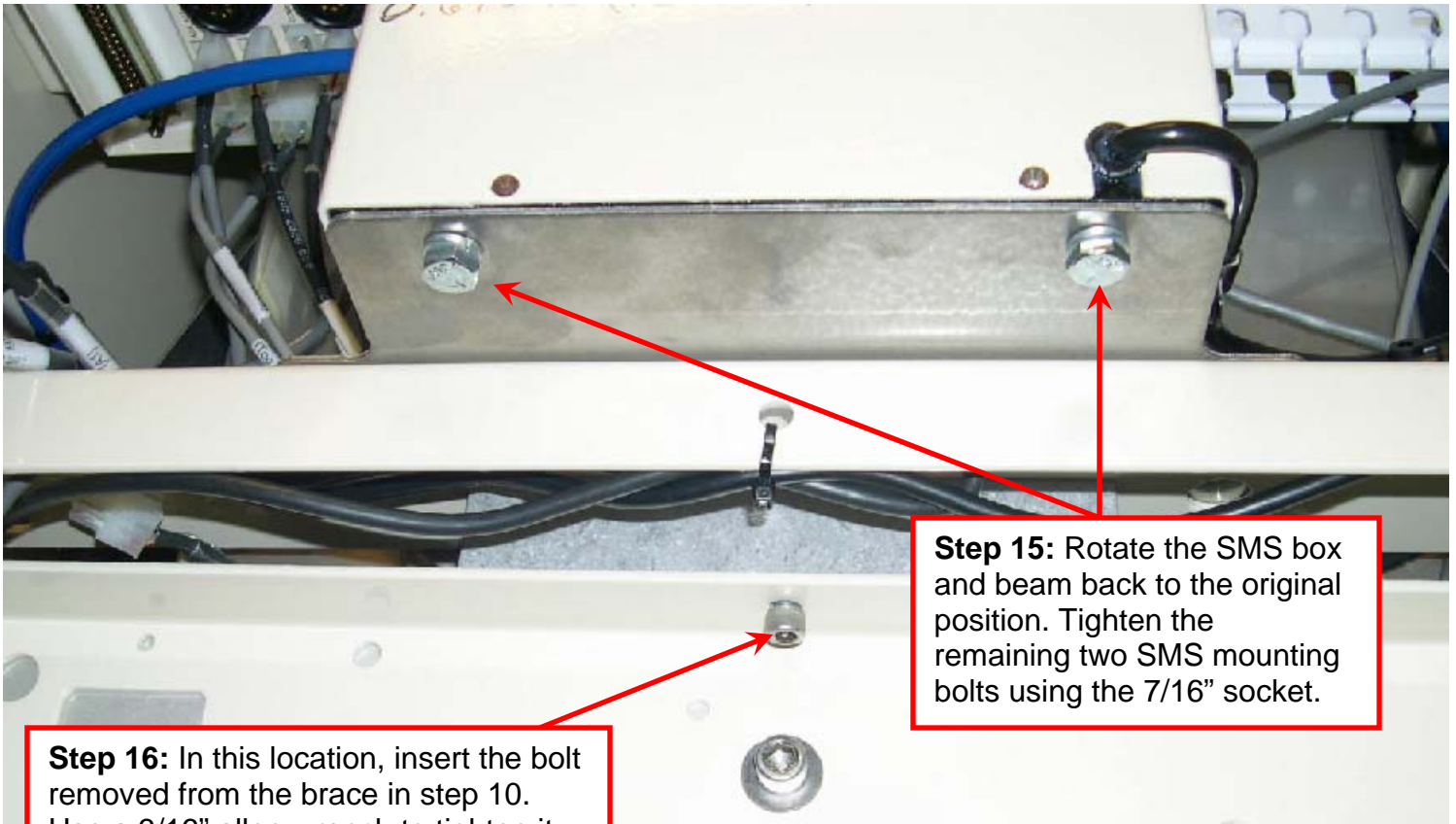

**Step 15:** Rotate the SMS box and beam back to the original position. Tighten the remaining two SMS mounting bolts using the 7/16" socket.

**Step 16:** In this location, insert the bolt removed from the brace in step 10. Use a 3/16" allen wrench to tighten it.

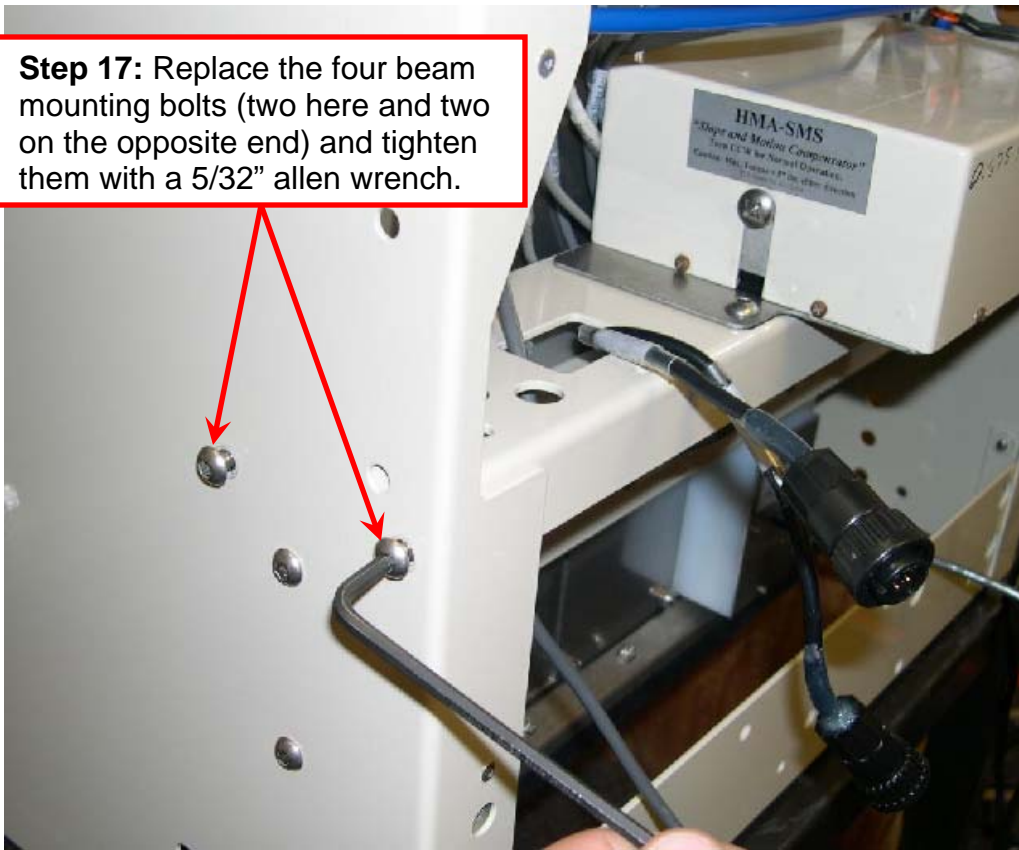

**Step 17:** Replace the four beam mounting bolts (two here and two on the opposite end) and tighten them with a 5/32" allen wrench.

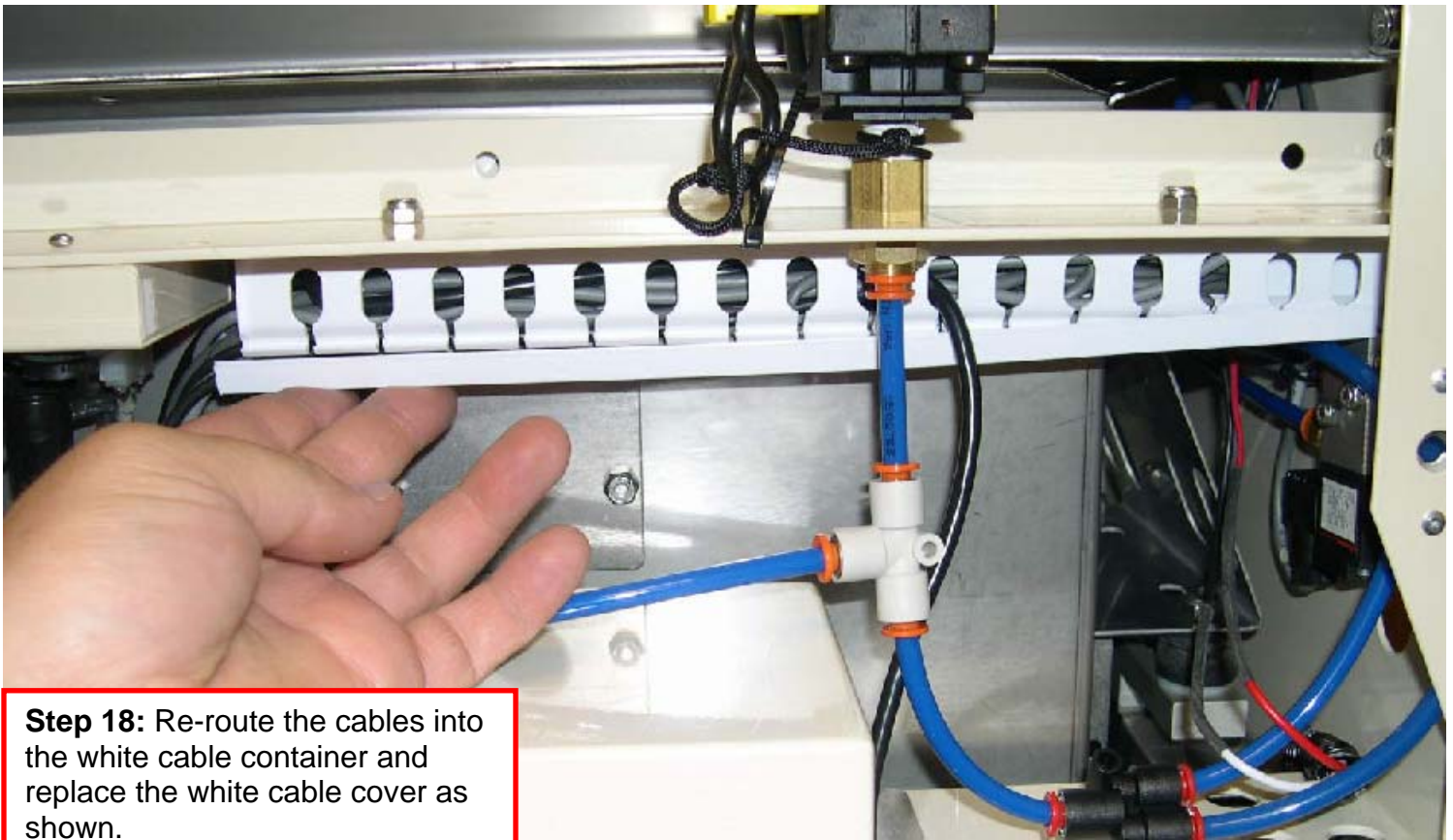

**Step 18:** Re-route the cables into the white cable container and replace the white cable cover as shown.

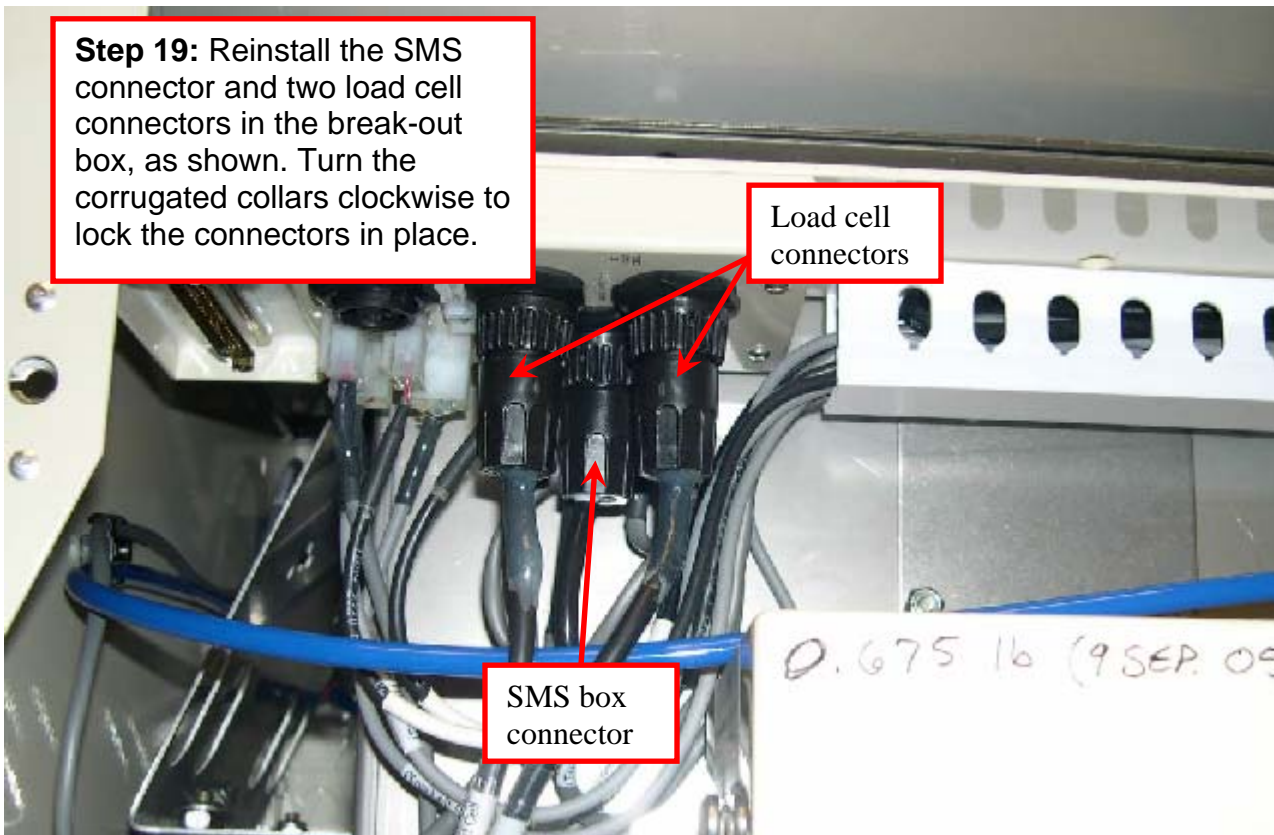

**Step 19:** Reinstall the SMS connector and two load cell connectors in the break-out box, as shown. Turn the corrugated collars clockwise to lock the connectors in place.

Load cell connectors

SMS box connector

0.675 16 (9 SEP. 05)

## **Step 20: Preparing the HCGG for use**

Now that you have installed your SMS box, follow these steps to return your HCGG to its original position:

1. Place the door back onto the HCGG.
2. Slide the HCGG back toward the combine.
3. Close the locking mechanisms on the HCGG.

## **Step 21: Changing the SMS weight on your field computer**

If you are replacing a 4-lb SMS box with a .675-lb box, you need to change the existing SMS reference weight in your field computer to 0.675 U.S. units. To do this, complete the following steps:

1. Turn on your HM-401 SCCU and wait for the field computer to boot to the *Main Menu* screen of the HCGG software.
2. On your field computer, select from the *Main Menu* screen *Setup / Weight/Bucket / S & M Sensor*.

*Note: Be sure the shipping stop on the SMS is disabled, the combine is on a level surface, and the thresher is turned off.*

3. Follow the screen prompts on your field computer and then key in "Ref Wt" (Reference Weight) when the combine is still and level.
4. Enter 0.675 U.S. units in the Ref Wt to enable the slope and motion for normal HCGG usage.

*Note: The sensor cannot be enabled unless it is connected to the SCCU and HCGG. The combine should be level and stable when enabling.*

5. Press *Enter* to accept the Ref Wt selection and return to the Weight/Bkt menu.
6. Write the new reference weight on the side of the SMS box, as seen on page 11.

## **Contact Information**

Your HCGG and Slope and Motion Sensor should now be ready to use. If you have any questions regarding installation or use of this SMS box, please contact our Service Department.

Phone: 435-753-1881 (8 am to 5 pm, MST)  
435-757-5354 (after hours)  
E-mail: techsupport@junipersys.com  
Website: www.junipersys.com